

This document describes how to connect the device to the wireless network via a wireless LAN router or access point.

Check the access point or wireless router where the device will have to be connected to. Make sure that is using 2.4GHz and b, g or n mode for the wireless communication. For specific information about the wireless access point or router, please refer to their corresponding manuals.

Make sure that the device is close enough to the wireless access point or router so there are no coverage issues.

- 1 Connect your device to the AC unit according to the instructions of the installation manual.

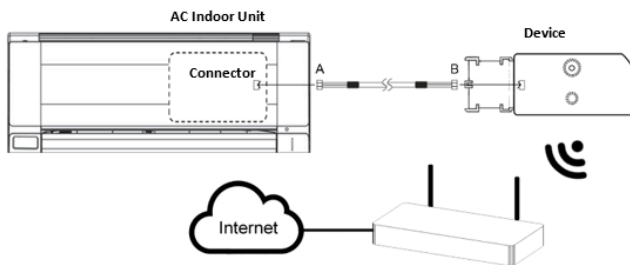

- 2 Download the application from Google Play or App Store.



Direct access to download links can be found at [www.airconwithme.com](http://www.airconwithme.com)

- 3 Visit the wireless settings section of your wireless device (smartphone, tablet or laptop) and connect to the network generated by your device (DEVICE\_xxxxxx).

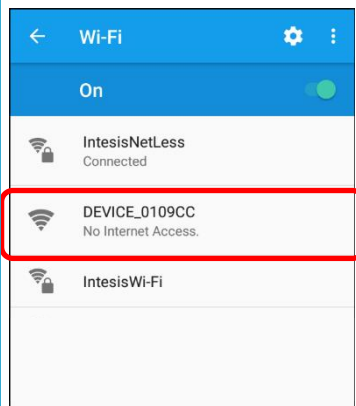

- 4 Click on the add device Button. \*\*

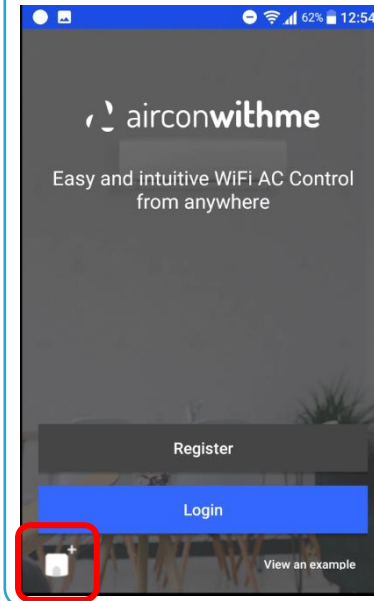

- 5 Click on "Start".

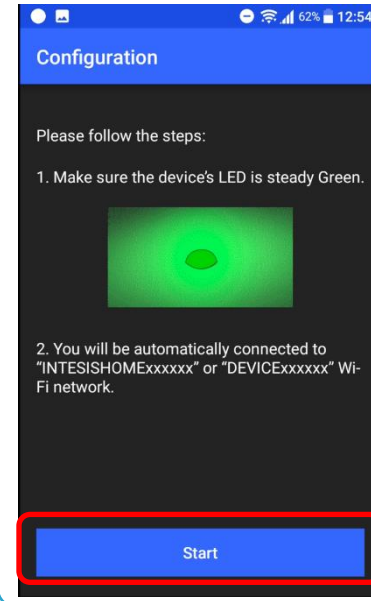

- 6 Select "Automatic".

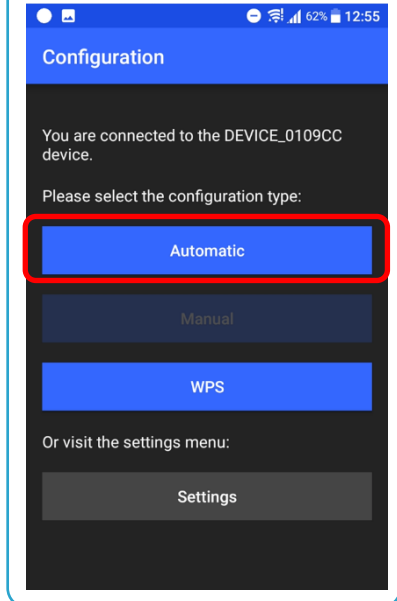

- 7 Select the wireless network the device will be connected to.

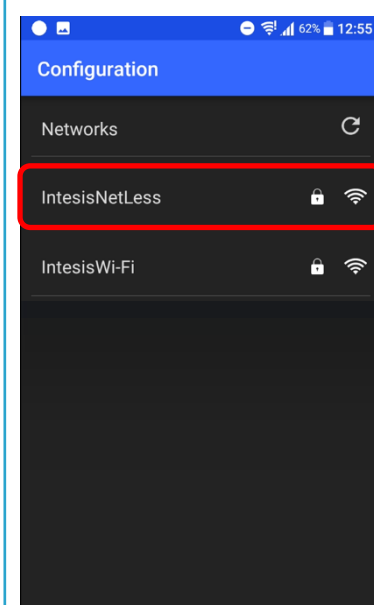

- 8 Introduce the wireless network password.

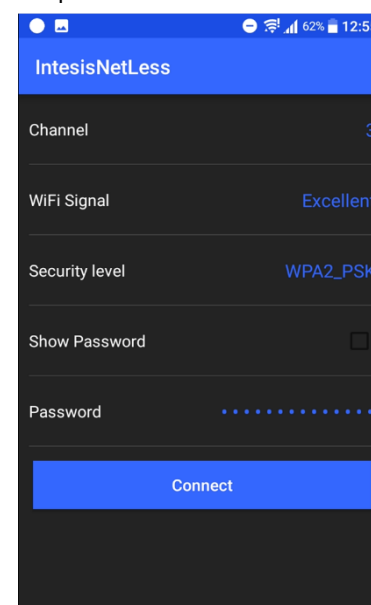

- 9 Process completed. \*\*\*

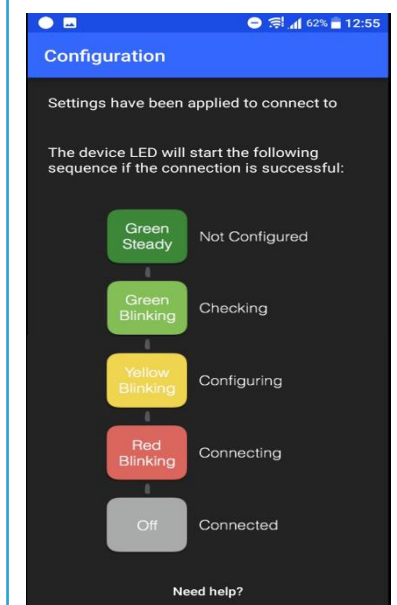

\*Check your wireless device (smartphone, tablet or laptop) user manual for more information on how to enable a wireless network connection.

\*\* **IMPORTANT:** This view is only available if you are not logged into the account.

\*\*\* If configuration process is not finished as expected, try the complete process again. If problem persist, contact our support team.